

WATER-COOLED TIG WELDING TORCH GPG-18 SC

Rating: 410A DC, 290A AC @100% duty cycle.

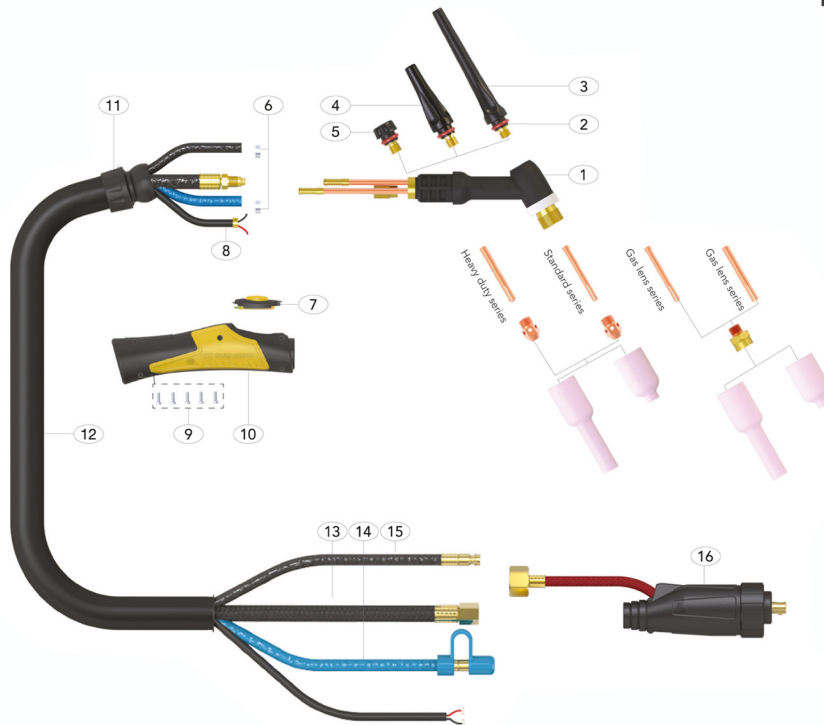

Model	Part Number	
Description	12ft	25ft
GPG-18 SC	CWSG18SC-S1-12-4M	CWSG18SC-S1-25-8M

Spare parts

Part Number	Description		
1	UWP18SC	Torch Body	
2	U98W18	Back Cap 'O' Ring	
3	U57Y02	Back Cap Long	
4	U300M	Back Cap Medium	
5	U57Y04	Back Cap Short	
6	UB5041	Hose Clamp 8.7mm	
7	EK-ER1MS-BF	ECE Momentary Kit	
8	3100224216-4.2	Switch Wire 4m	
	3100224216-7.7	Switch Wire 8m	
9	UERSP1	Screw Pack	
10	EKH200	Large Ergo Tig Handle	
11	PT-ERKJ200	Large Knuckle Joint	
12	PL200-40	Neoprene Cover Assembly x 4m	
	PL200-80	Neoprene Cover Assembly x 8m	
13	PGD40V64OB-EPC2	Power Cable x 4m O/B Rubber	
	PGD41V29OB-EPC2	Power Cable x 8m O/B Rubber	
14	PL45V07-WF1	Water Hose X 4M PVC	
	PL45V08-WF1	Water Hose X 8M PVC	
15	PL45V09-GS4	Gas Hose x 4m PVC	
	PL45V09-GS4	Gas Hose x 8m PVC	
16	UML3550-M12-M-W7	Power Adaptor 8.9mm QF	